

## Carbon Monoxide Sensor CM8

**Product name:** CO SENSOR

**Product number:** CM 8

**Category:** Electrochemical gas sensor

### Carbon Monoxide Sensor



**CM 8**

**EN 50291-1:2010**

**CE**

**EMC**

**RoHS**

**Features:**

1. More than ten years long life, electrochemical principle
2. Low sensitivity to ethanol;
3. Can reduce the influence of various interference gases, good linear output characteristics;
4. Consistency is very good;
5. The carbon monoxide gas selectivity and repeatability is very good;
6. The sensor signal output and the concentration of carbon monoxide gas into a linear relationship;
7. The leading production technology and new advanced materials;
8. Electrolyte pollution, materials comply with RoHS requirements;
9. Strong anti-interference;
10. The shell thicker will never rust, the new material used in component feet is conductive.

**Typical Applications:**

1. Carbon monoxide detector alarms
2. Car alarms
3. Smart furniture
4. Commercial carbon monoxide detector
5. Industrial carbon monoxide detector
6. Indoor parking ventilation control
7. Portable carbon monoxide concentration meter
8. CO detection alarm.

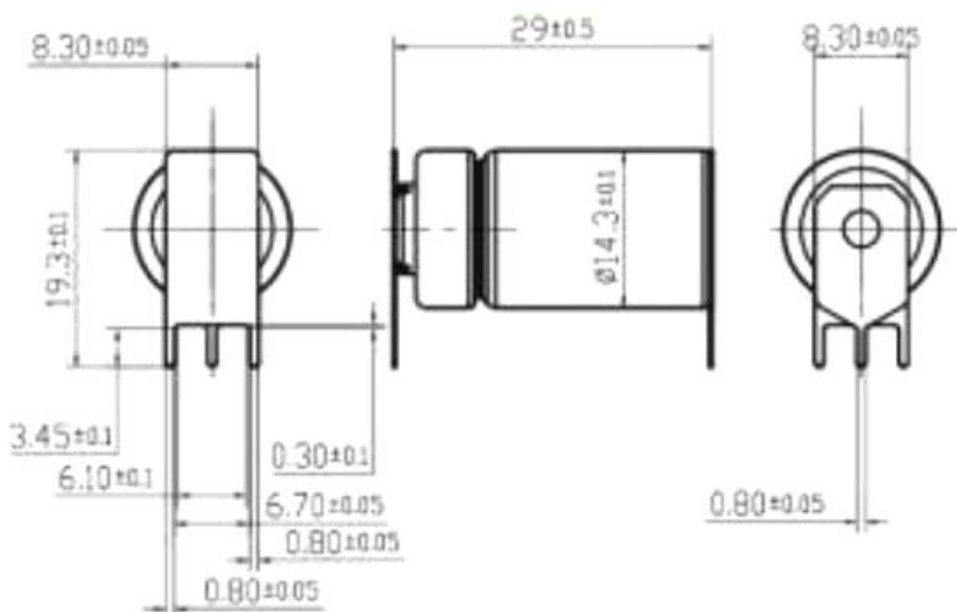

**Main parameters:**

1	Length	29.3±0.1mm
2	Height	19.3±0.1mm
3	Body diameter	14.3±0.1mm
4	Pin Length	3.45±0.1mm
5	Pin spacing	29±0.5mm
6	Detection accuracy	< 3%
7	Detection range	0-10000
8	output current	0.8 - 2.0 nA/ppm
9	response time	< 30s
10	High concentration recovery time	< 30M
11	Working humidity	5 - 99%RH
12	repeatability	1% F.S
13	hysteresis	1% F.S
14	drift	1
15	sensitivity	1
16	material	Green polymer
17	Protection class	IP55
18	Operating temperature	-10 ~ 60 °C
19	Lifetime of product	10 years